



OSPREY

FOR THE AVID FISHERMAN | [OSPREYBOATS.COM](https://ospreyboats.com)

TABLE OF CONTENTS

WHY OSPREY	04	28' ENDEAVOR	14
24' TALON	08	30' DESTINATION & 30' FREEDOM	16
26' LEGEND	10	CUSTOMIZATION OPTIONS	18
26' STORM	12	WARRANTY	24









WHY OSPREY?

WORLD CLASS PILOTHOUSE SPORT FISHING BOATS

Since 1989, Osprey Boats have been one of the premier sport fishing boats in the Pacific Northwest. Now being built by the most experienced fiberglass boat builder in America, Osprey understands the level of quality expected from buyers in the competitive boat building market and demands superior standards from every boat they manufacture.

Osprey boasts unsurpassed performance and value with each of their models, offering one of the highest quality fishing boats in the industry. Osprey upholds a steadfast commitment to superior craftsmanship, and the difference is easy to see.

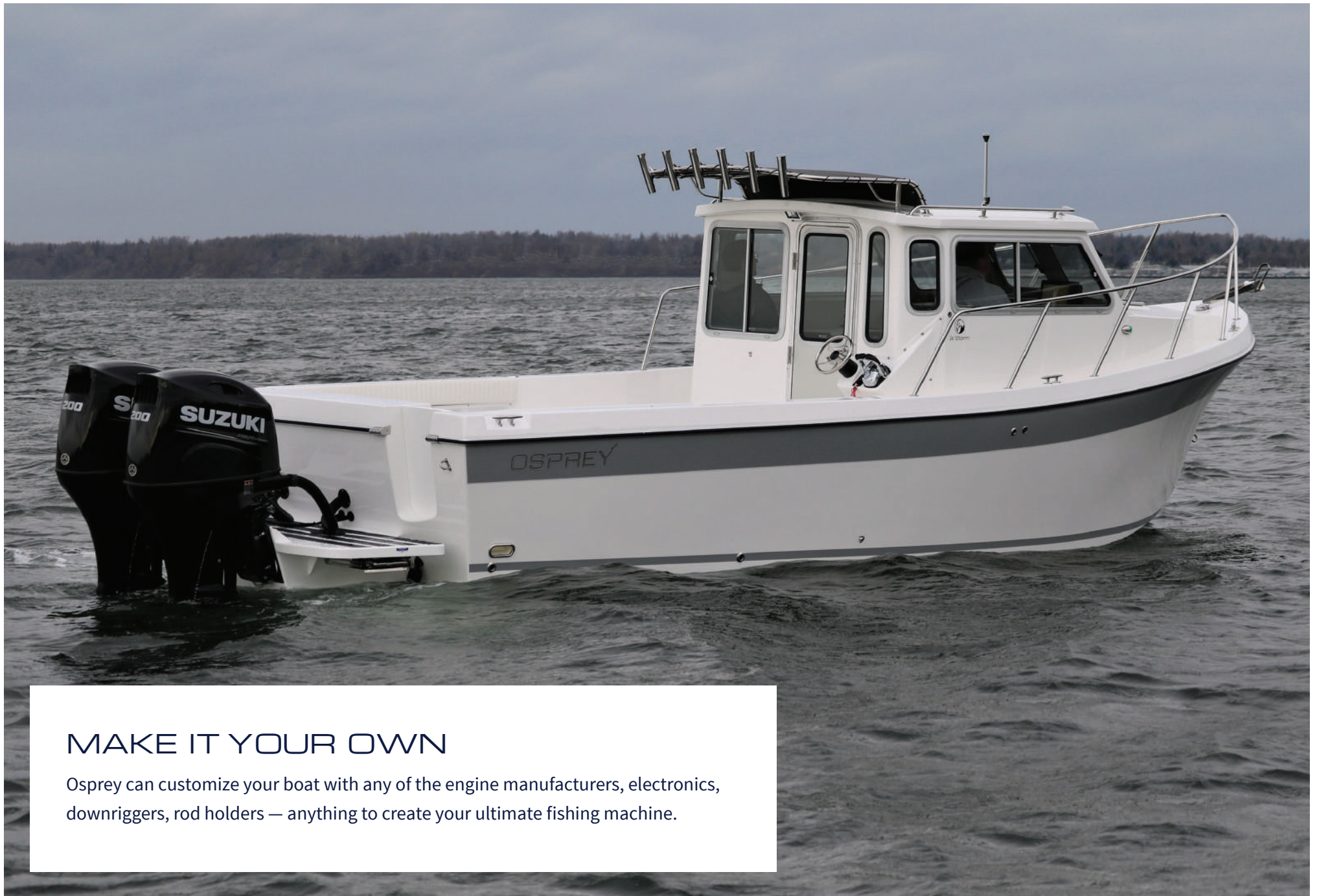

MAKE IT YOUR OWN

Osprey can customize your boat with any of the engine manufacturers, electronics, downriggers, rod holders — anything to create your ultimate fishing machine.



VENTURE BOLDLY

Osprey offers unbeatable quality in all of our pilothouse sport fishing boats. Your investment is not only top of the line, but it gives you the ultimate stability available so that each outing is smooth, comfortable, and fun.



24' TALON

A RUGGED FISHING CRUISER

The 24' comes complete with a galley counter and sink, windshield defrosters, insulated cabin, and all fiberglass interior. While everyone is relaxing in the cabin, the avid fisherman can take advantage of the large 56 sqft self-bailing deck — perfect for wrestling that record-setting halibut. Small enough to trailer and maneuver around docks, the 24' Talon can take you many miles offshore with greater speed and stability than most cruisers.

FEATURES

- 150 gallon fuel capacity provides great range
- 22" aluminum framed hatch with tinted lens
- Cabinetry is composed of fiberglass
- Built to accommodate single or twin motors
- Tremendous fuel efficiency
- Galley complete with sink and pressurized water

COMMANDING PERFORMANCE & OPTIMUM HANDLING THAT DOESN'T COMPROMISE STYLE OR COMFORT

LENGTH

24'0"

FUEL CAPACITY

150gal

WATER CAPACITY

30gal

BEAM

8'6"

WEIGHT (DRY)

5200lbs

SLEEPS

4

SPECS

Length	24'
Beam	8'6"
Cabin Headroom	6'4"
V-Berth Length	6'10"
Cabin Size	7' x 6'6"
Cockpit Size	7' x 8'
Fuel Capacity	150gal
Water Capacity	30gal
Waste Capacity	Optional
Displacement	5200lbs (dry)

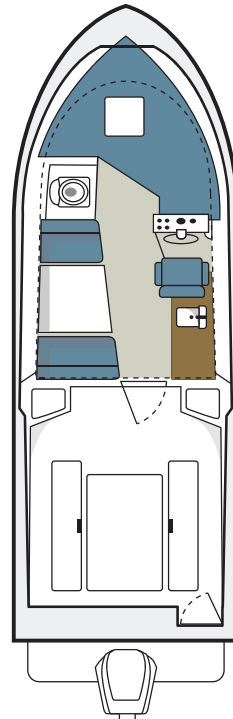



26' LEGEND

PERFECT FOR FAMILIES

With more living space, a larger galley, and a huge deck, the Osprey 26' Legend gives greater livability for families while offering the high performance and quality you've come to expect from Osprey. Additional options include a stainless anchor windlass and flip-flop cabin seat that allows you to face forward or turn around and join the party at the spacious dinette. If you have a big family or just need the extra room, the 26' Legend is the ideal choice.

FEATURES

- Fabric upholstery
- Transom door and swim step
- Bluetooth stereo system with cabin speakers
- Full galley with an extra deep sink
- 30 amp shore power system complete with battery charger
- Seawater wash-down system
- All stainless-steel hardware

EXTRA BREATHING ROOM WITH THE PERFORMANCE YOU'D EXPECT FROM A POWER FISHING CRUISER

LENGTH

26'0"

FUEL CAPACITY

150gal

WATER CAPACITY

30gal

BEAM

8'6"

WEIGHT (DRY)

6500lbs

SLEEPS

4

SPECS

Length	26'
Beam	8'6"
Cabin Headroom	6'4"
V-Berth Length	6'10"
Cabin Size	9' x 6'6"
Cockpit Size	7' x 8'
Fuel Capacity	150gal
Water Capacity	30gal
Waste Capacity	12gal
Displacement	6500lbs (dry)

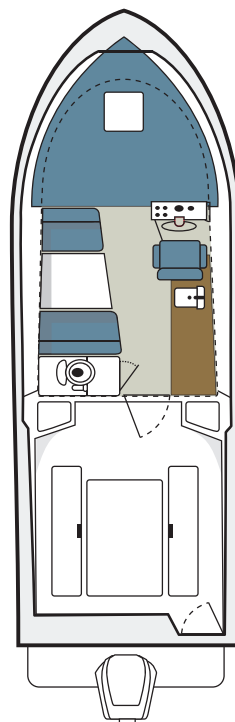



26' STORM

STRETCH YOUR SEA LEGS

The Osprey 26' Storm offers all the perks and quality performance of the 24' Talon, but with the added two feet of length in the aft deck, which any fisherman knows can mean the difference between the trophy fish on the wall or 'the one that got away.' Designed for superior maneuverability, you'll be able to weave your way to the supreme fishing sites with ease. For convenient access, the design has a full-height waterproof door and level entry.

FEATURES

- Full-length fiberglass stringers
- True walk around deck protected by high-grade marine stainless steel rails
- Full-height waterproof door
- Full galley with sink and pressurized water
- LED interior cabin lighting

SAME QUALITY PERFORMANCE OF THE 24' TALON WITH TWO ADDED FEET OF LENGTH TO THE AFT DECK

LENGTH

26'0"

FUEL CAPACITY

150gal

WATER CAPACITY

30gal

BEAM

8'6"

WEIGHT (DRY)

6000lbs

SLEEPS

4

SPECS

Length	26'
Beam	8'6"
Cabin Headroom	6'4"
V-Berth Length	6'10"
Cabin Size	7' x 6'6"
Cockpit Size	7' x 10'
Fuel Capacity	150gal
Water Capacity	30gal
Waste Capacity	Optional
Displacement	6000lbs (dry)

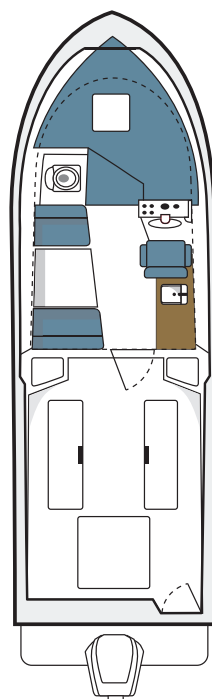



FULLY PACKED WITH AMENITIES

The Osprey 28' Endeavor is the boat you've been waiting to take on the water. Outstanding construction and lots of room to comfortably sleep a family of four. With twin power plants, the 28' Endeavor delivers true offshore dependability and optimal speed. Rugged and powerful, with incredible performance, it's perfect for getting to the best fishing sites, and the 64 square foot aft deck ensures the serious fisherman ample space to fight with the biggest catch of the sea!

FEATURES

- Stand-up head with shower
- Full galley with an extra deep sink
- Full walk around deck protected by high-grade marine stainless steel rails
- Stainless anchor windlass
- Extended hardtop

DELIVERING ALL THE FEATURES AND SPACIOUSNESS THAT MAKES TRAVEL MORE RELAXING

LENGTH

28'0"

FUEL CAPACITY

205gal

WATER CAPACITY

35gal

BEAM

9'6"

WEIGHT (DRY)

9750lbs

SLEEPS

4

SPECS

Length	28'
Beam	9'6"
Cabin Headroom	6'4"
V-Berth Length	7'8"
Cabin Size	9'9" x 7'
Cockpit Size	8'8" x 7'
Fuel Capacity	205gal
Water Capacity	35gal
Waste Capacity	15gal
Displacement	9750lbs (dry)

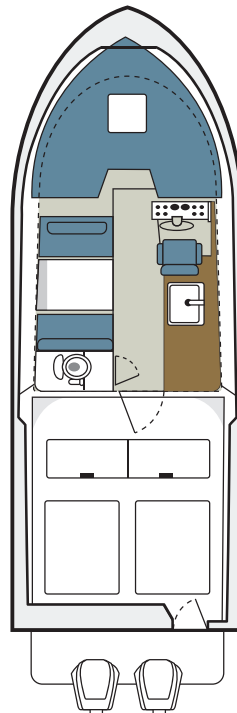



30' MODELS

UNBEATABLE QUALITY

Our 30' has the smoothest ride of any deep-V cruiser, and with two models to choose from, you can tailor it to fit your family's needs. With room to sleep six people comfortably, they are ideal for making extended excursions even more inviting. Plus, a 76 square foot aft deck gives the hard-core angler plenty of room to reel in the largest catch of the day. But don't worry, you won't sacrifice any power: optional twin diesels or twin outboards provide 40+ mph and a 450-mile cruising range!

FEATURES

- 360° visibility, full walk around deck
- Stand-up head with heated shower
- Equipment room
- Loads of storage space
- Large refrigerator and microwave
- 30 amp shore power complete with charger
- Stern drive or outboard options

THIS SPORT FISHING BOAT IS IDEAL FOR MAKING EXTENDED EXCURSIONS EVEN MORE ENJOYABLE

LENGTH

30'0"

FUEL CAPACITY

300gal

WATER CAPACITY

36gal

BEAM

10'0"

WEIGHT (DRY)

11,000lbs

SLEEPS

6



30' FREEDOM SPECS

Length	30'
Beam	10'
Cabin Headroom	6'6"
V-Berth Length	7'8"
Cabin Size	9'6" x 7'7"
Cockpit Size	11' x 8'
Fuel Capacity	300gal
Water Capacity	36gal
Waste Capacity	21gal
Displacement	11,000lbs (dry)

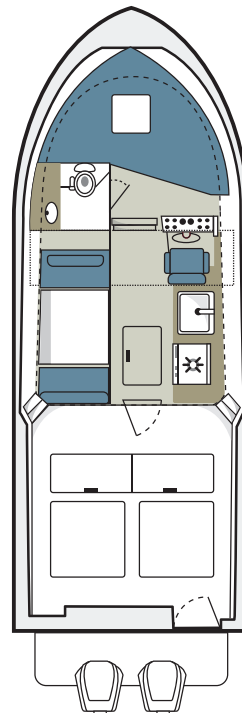

30' DESTINATION SPECS

Length	30'
Beam	10'
Cabin Headroom	6'6"
V-Berth Length	7'8"
Cabin Size	11' x 7'7"
Cockpit Size	9'6" x 8'
Fuel Capacity	300gal
Water Capacity	36gal
Waste Capacity	21gal
Displacement	11,000lbs (dry)

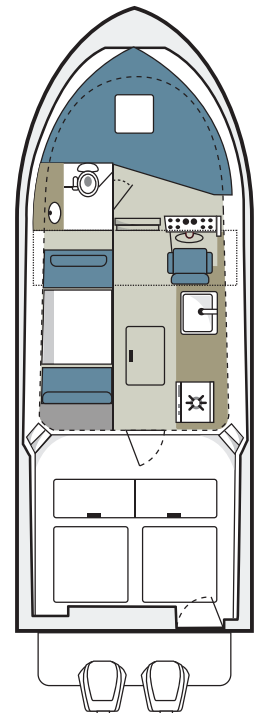





ULTIMATE FISHING MACHINE

REVEL IN YOUR ELEMENT

There is no other boat out there like an Osprey. From power, maneuverability, open-ocean excursion capabilities, and the little luxuries that make the difference, Osprey goes the extra mile to ensure that each outing you take your boat on is just as comfortable as the last.

POWER

Through sea trials and owner testimonials, we have determined what outboard power is best suited for each boat and we can rig boats with outboard power preferred by the owner.



HONDA



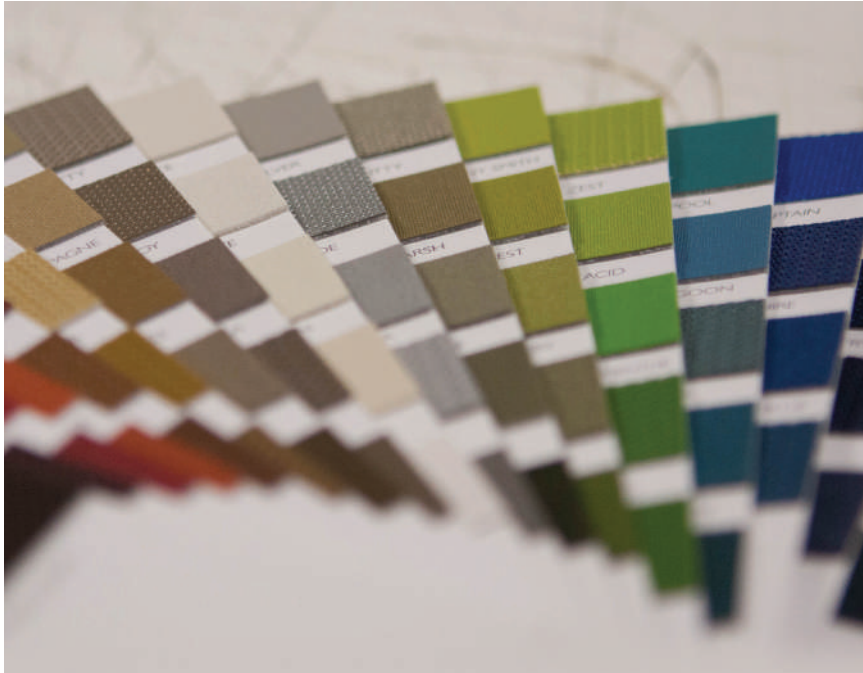

UPHOLSTERY

All tastes are different so we figure we should honor that. Our custom upholstery department can cut, shape, mend, hem any type of fabric in any color or size. We offer a broad range of products to choose from. We can also build custom cushions depending on body frame and preferences.



AESTHETICS

Selecting the right color combination for your Osprey is often not easy as they all look so glorious. We offer many different color options and layouts to fit any desire. We match you up with real life color chips to make sure the choice is right for you.



EQUIPMENT

There are some really nice additions that we can install at the factory. From pole holders to anchor windlasses, we take you through our equipment lists and talk about locations, operations, and functionality and suit the equipment to your needs.



ACCESSORIES

Lights, tackle boxes, wood trim are a few of the many options we can discuss getting into the boat at the factory. We're not a monster factory floor with robots and strict assembly lines. Our boats are built by hand for each individual owner. Getting to this level of detail is what differentiates Osprey from the other fishing vessels.



CONFIGURATIONS

Osprey proudly offers boat models from 24-30 feet. The models are tried and true, and offer reliability, luxury, and performance. Osprey boats are custom built the way you want them. We embrace the factory connection, so give us a shout!





WARRANTY & OWNERSHIP

As a family owned business we take our reputation very seriously. Our warranty is more than just words and a sales tool. If you have a problem, please feel free to call our factory and talk with one of our owners. We will get to the bottom of the issue and correct it. No other boat in our class can touch our coverage, our level of support, and our commitment to you as a boat owner.

10 YEAR
STRUCTURAL WARRANTY

5 YEAR
VESSEL FACTORY
COMPONENT WARRANTY

3 YEAR
GELCOAT FINISH
WARRANTY



TOO GOOD TO BE TRUE?

Cruising around in an Osprey boat is all about quality and performance. Above all, we want you and your family to cherish every outing on the water.





MADE IN  THE USA

809 HARRIS AVENUE, BELLINGHAM, WA 98225 PH 360-389-5351 WWW.OSPREYBOATS.COM  